

Price: 250,000 €

Ref: R4411630

Bedrooms: 0

Bathrooms: 0

Built size: 0 m²

Plot/Garden: 605 m²

Terrace: 0 m²

RESIDENTIAL PLOT FOR SALE IN MIJAS

Consolidated urban plot, in Campo Mijas, at the top of the mountain near the town of Mijas, located in an enclave of pine forests and pinzapos with the best views of the Costa del Sol, luxury urbanization of a group of villas of great value.

This plot has a project to execute a Luxury Villa, a Single Family home, with an occupancy rate of 55%, and two floors.

Area of ??very high demand, with very few possibilities to build, with a low urban density and a landscape nestled in pure Nature.

Precio no incluye gastos ni tributos. Gastos adicionales por parte del comprador: Impuesto Sobre Transmisiones (8% hasta 400.000€, 9% de 400.000 a 700.000€ y 10% a partir de 700.000€), Actos Jurídicos Documentados 1,5% sobre el precio de compra, gastos de registro y notaría. Ficha informativa a su disposición en nuestra oficina según Decreto 218/2005 de 11/Oct.

Sale price does not include costs or taxes. Additional costs for the buyer: inscription and notary fees, ITP (8% up to 400.000 euros, 9% from 400.000 to 700.000 euros and 10% from 700.000 euros) or, alternatively 10% VAT and AJD (1.5% on the purchase price) on new properties and subject to some requires to be met. This info is subject to errors, omissions, modifications, prior sale or withdrawal from the market. Information sheet available, Decree 218/2005 Oct. 11th

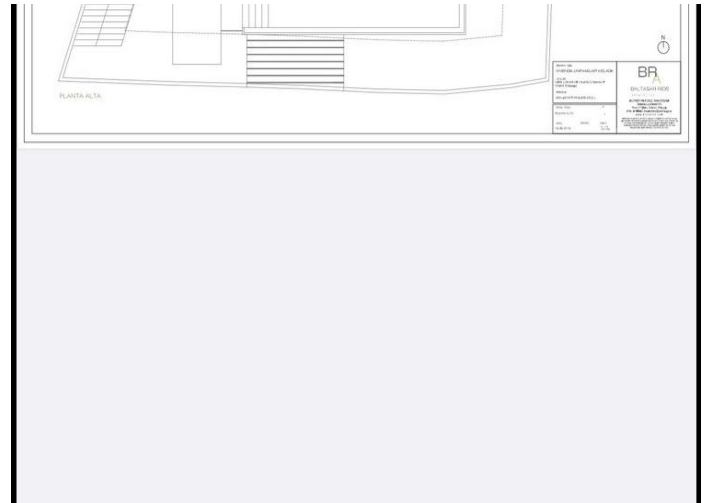
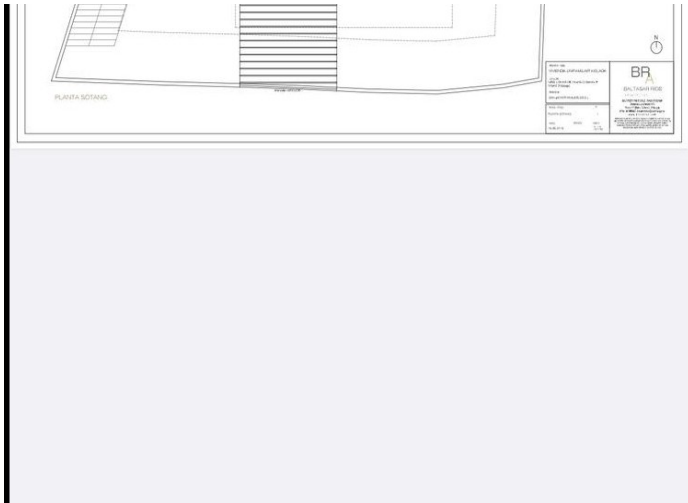
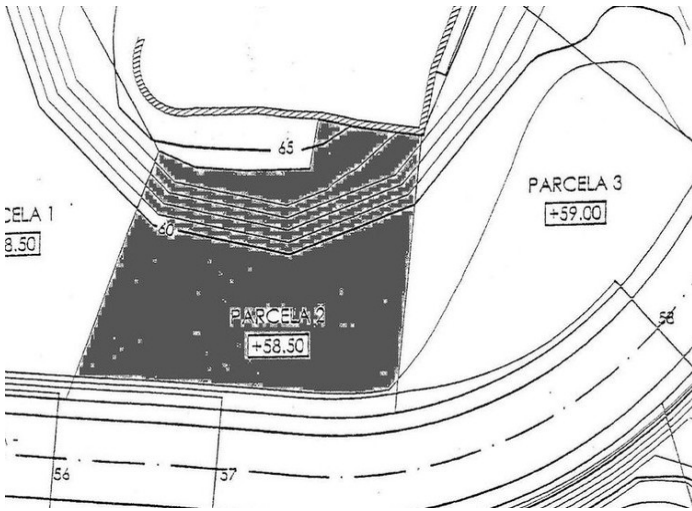
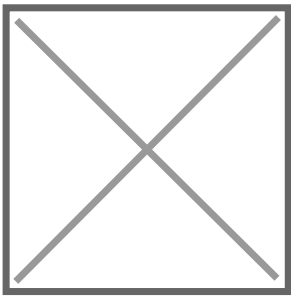

Precio no incluye gastos ni tributos. Gastos adicionales por parte del comprador: Impuesto Sobre Transmisiones (8% hasta 400.000€, 9% de 400.000 a 700.000€ y 10% a partir de 700.000€), Actos Jurídicos Documentados 1,5% sobre el precio de compra, gastos de registro y notaría. Ficha informativa a su disposición en nuestra oficina según Decreto 218/2005 de 11/Oct.

Sale price does not include costs or taxes. Additional costs for the buyer: inscription and notary fees, ITP (8% up to 400,000 euros, 9% from 400,000 to 700,000 euros and 10% from 700,000 euros) or, alternatively 10% VAT and AJD (1.5% on the purchase price) on new properties and subject to some requites to be met. This info is subject to errors, omissions, modifications, prior sale or withdrawal from the marke. Information sheet available, Decree 218/2005 Oct. 11th